



Poly-Plus “u” Values

When using Rackham Poly-Plus system it is first necessary to calculate the ratio of perimeter over area of the floor (P/A)

From the tables below you can then calculate the “u” value.

Poly-Plus

P/A Ratio	“u” Value W/m ² K
0.4	0.21
0.5	0.21
0.6	0.22
0.7	0.22
0.8	0.22
0.9	0.22

Poly-Plus Panel

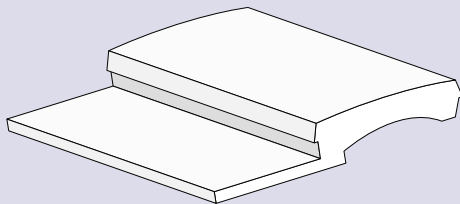

Poly-Plus Extra

P/A Ratio	“u” Value W/m ² K
0.4	0.17
0.5	0.18
0.6	0.18
0.7	0.18
0.8	0.19
0.9	0.19

Poly-Plus Extra Panel

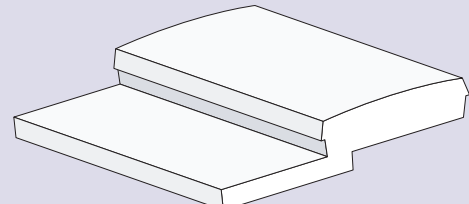

Poly-Plus F/T Flat Top

P/A Ratio	“u” Value W/m ² K
0.4	0.17
0.5	0.18
0.6	0.18
0.7	0.18
0.8	0.19
0.9	0.19

Poly-Plus F/T Flat
Top Panel

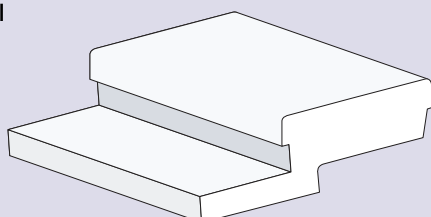

The average slab “u” value is slightly dependent on the number and type of concrete perimeter blocks within the floor area, use of multiple concrete joists and floor finishes, and must be taken into account in any calculation.

The “u” values quoted are for guidance only and should be confirmed with our Technical Department before any orders are placed.