



Poly Plus

The original Rackham Poly-Plus Panel offering “u” values as low as 0.21w/m²K and used to produce a thermally efficient floor where either NO membrane OR a very light gas membrane (1200 gauge or less) is required.

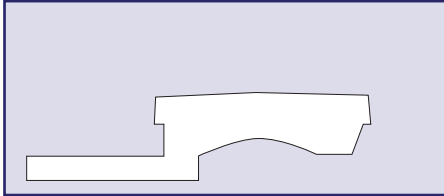

Fig 1. Poly Plus Panel

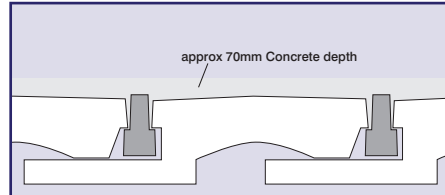

Fig 2. Floor construction using Poly Plus Panel with NO membrane

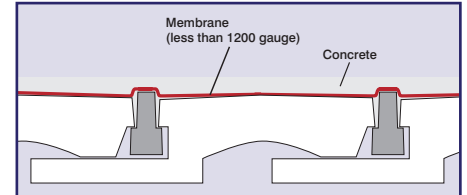

Fig 3. Floor construction using Poly Plus Panel with membrane barrier

Poly Plus Extra

Where “u” values as low as 0.17 w/m²K are required specify the Poly-Plus Extra Panel from Rackham Housefloors. This panel is used on sites with either NO membrane OR a very light gas membrane of 1200 gauge or less.

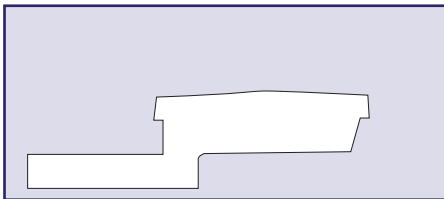

Fig 4. Poly Plus Extra Panel

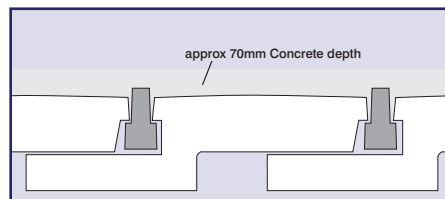

Fig 5. Floor construction using Poly Plus Extra Panel with NO membrane

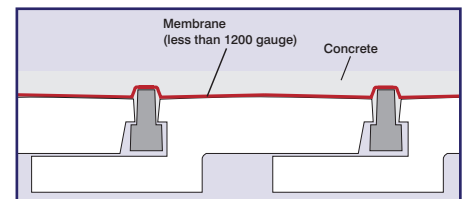

Fig 6. Floor construction using Poly Plus Extra Panel with membrane barrier

Poly Plus F/T Flat Top Panel

With “u” values as low as 0.17 w/m²K and where site conditions require a radon or gas membrane over 1200 gauge please use the Poly-Plus F/T panel.

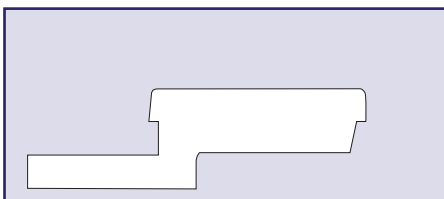

Fig 6. Poly Plus F/T Flat Top Panel

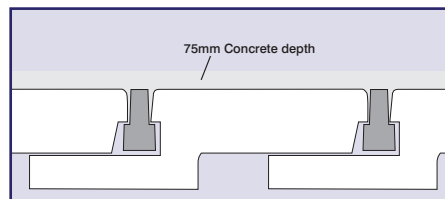

Fig 7. Floor construction using Poly Plus F/T Flat Top Panel with NO membrane

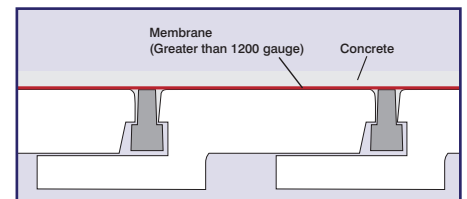

Fig 8. Floor construction using Poly Plus F/T Flat Top Panel with rigid membrane barrier

The structural concrete screed laid over the polystyrene panels should be a minimum 50mm thick **above the top of the beam** (overall depth approx 70mm) when using the Poly-Plus and Poly-Plus Extra panels as shown above OR 75mm thick when using the Poly-Plus F/T panel. The concrete should be grade 25 with a maximum aggregate size of 10mm and reinforced with either polypropylene fibres or A142 mesh.

Where RADON or GAS barriers are required, BBA Certified products should be used and installed in accordance with the appropriate Certificate.

Full details and specifications of the Poly Plus system can be found in our BBA Agrément certificate 85/1566.

Poly-Plus Panels to suit your site requirements